





# VALVE BODY 4KAI TYPE T

ART. NO. 440001

## GENERAL

-  The KEOFITT 4KAI Sampling Valve is our low cost sterilizable sampling valve for less demanding applications. Replaces non-hygienic sampling cocks. More than 20 different configurations available.
-  The sampling valve can be used for any process sampling for chemical and/or physical analysis.
-  **Cleaning/sterilizing:** Between batches: Valve in open position: Cleanable by means of CIP using the detergent solution suitable for the actual process media. Between samples: Valve in its normal closed position: cleanable by CIP as "Between batches" or the valve may be sterilized by means of steam SIP or chemical SIP using a procedure appropriate to the actual circumstances. For further advice, please contact Keofitt.
-  Designed for sampling of liquids with a viscosity of up to approx. 100 cP containing no particles larger than Ø1.5 mm. Sampling of more viscous liquids is possible, only will it take longer (depending on process pressure).

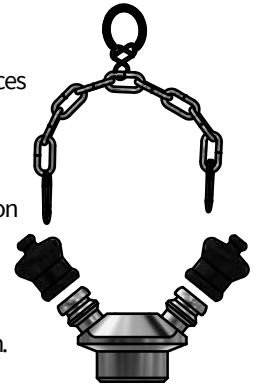

## FEATURES

-  Installation: Tank welding
-  Operation: Depending on choice of valve head
-  Inlet / Outlet: Hose piece
-  Membrane: Depending on choice of valve head

## CERTIFICATION\*

- EU EC 1935/2004 · EU EC 2023/2006 · DK No. 1248 10/2018 · 3-A Certificate · 3.1 Material Certificate
- ATEX 2014/34/EU · PED 2014/68/EU · Keofitt DoC

## TECHNICAL DATA

### Material (process contact)

- Steel parts                      AISI 316L (1.4404)

### Material (without process contact)

- Steel parts                      AISI 316L (1.4404)
- Rubber cap                      EPDM (black)
- Stainless steel chain            AISI 316L (1.4404)

### Surface Treatment

- Outside                          Ra <= 1.2 µm
- Inside (wetted surface)        Ra <= 0.8 µm
- Process connection            Ra <= 0.8 µm

### Pressure & Temperature

- Pressure                          Depending on choice of valve head
- Temperature                      Depending on choice of valve head
- Air supply                          Depending on choice of valve head

### Net Weight

- kg/lbs                              0.19 kg/0.419 lbs

### Spareparts

- 774401                              PARTS FOR 4KAI VALVE BODY

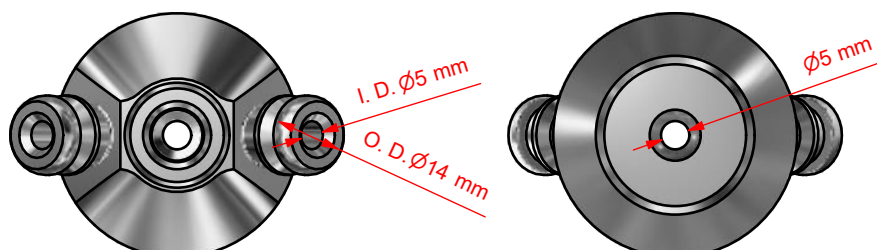
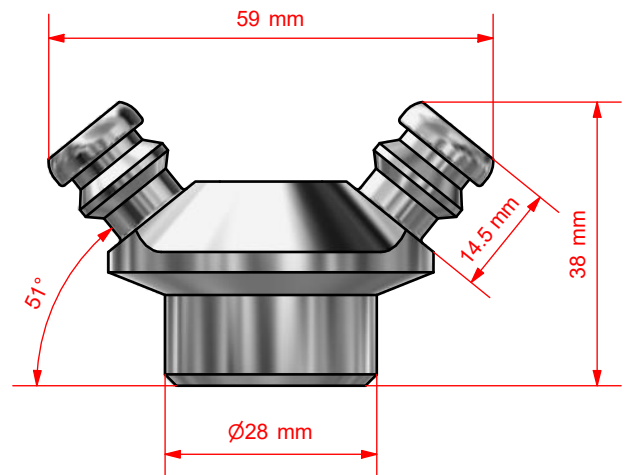

\*For further information and download please visit [www.keofitt.dk](http://www.keofitt.dk)